

L-Shaped Pop-up

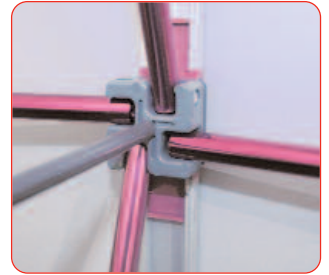

Light-weight highly versatile display system, ideal for exhibitions and trade fairs

features and benefits

- Quality anodised finish
- Self-locating 'smart' magnetic locking arms and low profile mag bars
- D-end graphic panels also fit the Quick Tower
- Available in a combination of quad sizes from 3x3 to 3 x 5 freestanding exhibition displays
- 3 quad graphic height 2225mm approx
- Accessories include choice of Lighting and Transit cases

Graphic Panel Sizes All measurements are in millimeters (mm)

Curved Widths	Front Panel	D-End
Reg	637	673

Straight Widths	Front Panel	Rear Panel	D-End
Reg	733	733	673

Panel Height	3 Quad
Reg	2225mm

Please note: That each L-shaped Pop-up has 2 curved panels on each frame. Rear graphics can only be fitted to straight sections

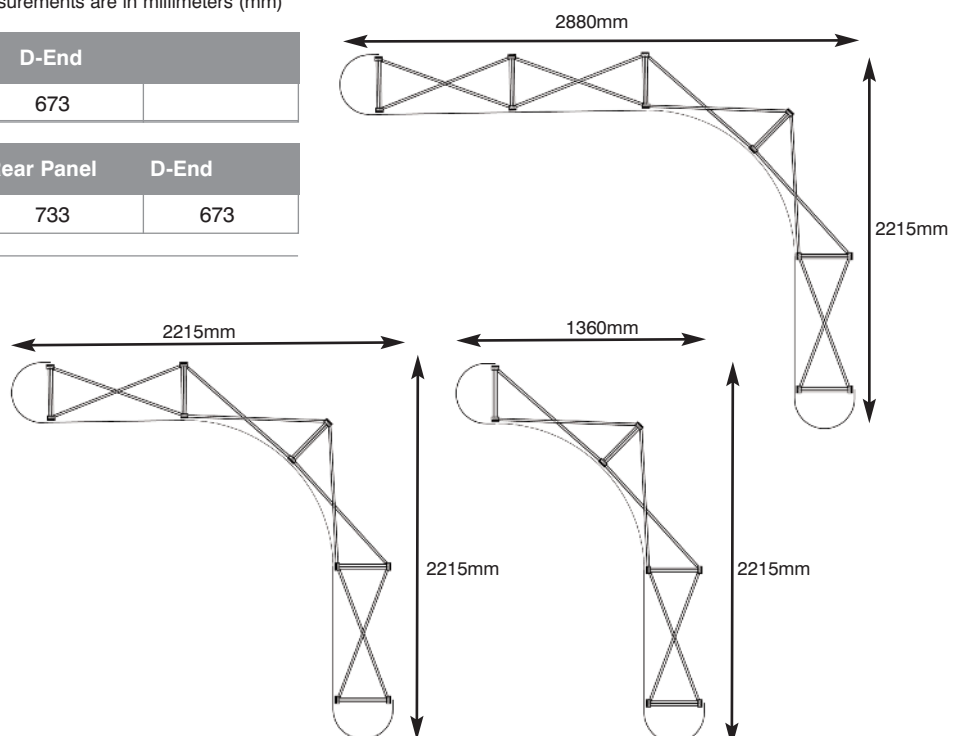

Assembly Instructions

Curved Graphic panel finishing



Remove the backing paper from the graphic hanger.



Apply the hanger to the top inside edge of the panel ensuring that it is flush to the panel edge.



Remove the backing paper from the kicker and apply to the bottom edge of the panel.



Remove the backing paper from the mag tape. Apply to both sides of the panel, keeping it flush to the edge.



NB D-End panels do not require kickers.

Curved Pop-up assembly

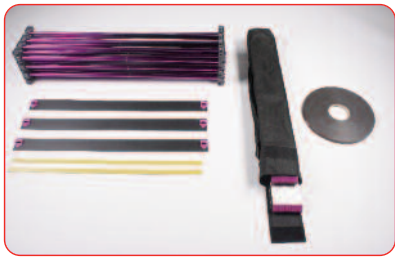

Kit includes: Pop-up frame, Mag Bars, hangers and kickers and mag tape



Take the frame, ensuring that the hanging studs are at the top. Stand the frame on the floor (2) and open up (3) until the locking arms lock the frame securely into place (4)

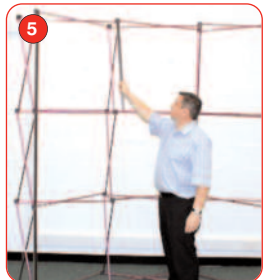
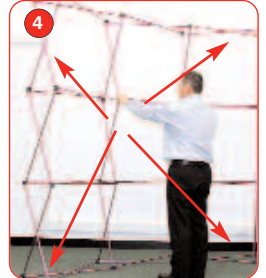
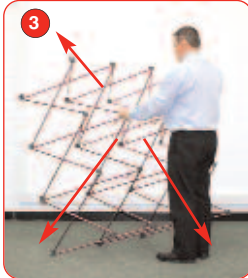

Add the mag bars onto the frame for front, D-ends and if applicable, the rear.

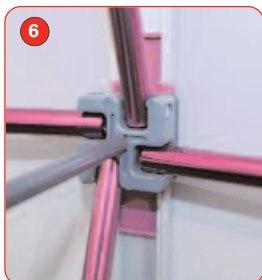

Ensure the mag bars lock onto the magnetic hubs securely.



Carefully hook the top hanger onto the studs of the top node.

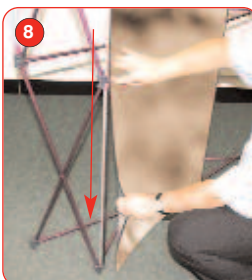

Smooth the graphic onto the mag bars, ensuring that it sits flat and is aligned to the centre line of each mag bar.

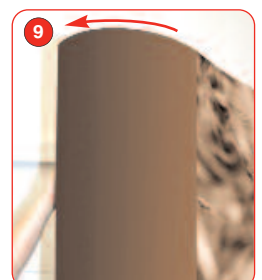

Attach the D-End panel front vertical edge. Curve the graphic round to the back and attach the back vertical edge to complete.



Repeat steps 8 and 9 for the rest of the graphic panels. This applies to front and rear graphics if applicable.

