

**A** Carry bag **B** 3 part bungee pole **C** Foot **D** Top and bottom rail

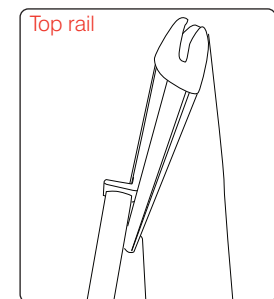
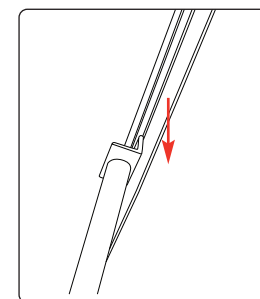
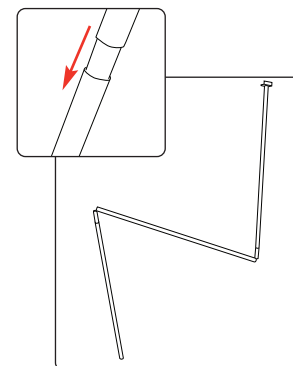
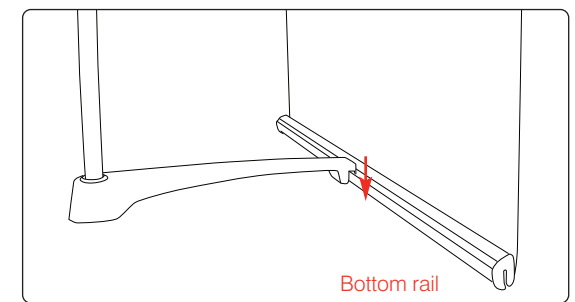
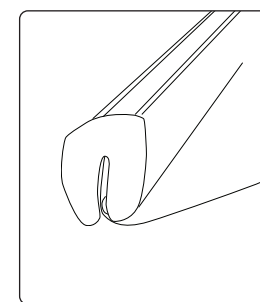
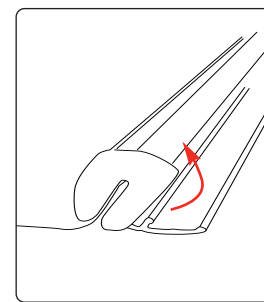
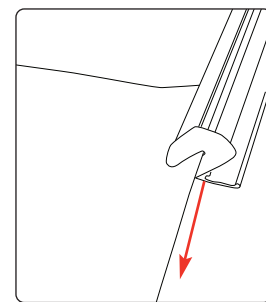
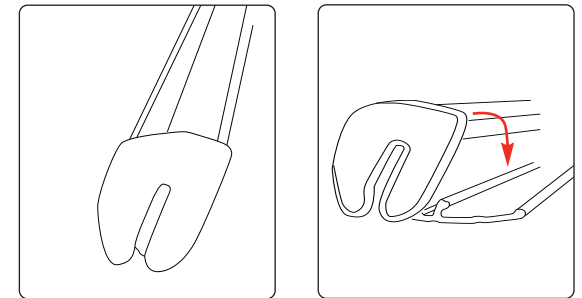

**Hardware specifications**

Assembled dimensions 2010mm(h) x 305(d) x 807(w) (based on 800mm wide unit)

**Graphic specifications**

Graphic Area: 2040(h) x 800/850/1000mm (w) actual  
2000(h) x 800/850/1000mm (w) visible

Recommended graphic material: 225-300 micron PVC